

Yealink CP925



Yealink

- 4-inch multi-touch screen with 480x800 resolution
- Optimal HD audio, full duplex technology
- Yealink Noise Proof Technology
- 20-foot (6-meter) and 360-degree voice pickup
- Built-in 6-microphone array for voice pickup
- Built-in 1-microphone array for noise cancellation
- Power over Ethernet
- 5-way conference call
- Built-in Wi-Fi (2.4GHz/5GHz, 802.11a/b/g/n)
- Built-in Bluetooth 4.2

TOUCH-SENSITIVE HD IP CONFERENCE PHONE

Yealink CP925 is a touch-sensitive HD conference phone designed for small to medium conference room. CP925 adopts a business and introverted design that perfectly matches the calm style of the conference room, but also a acoustics fabric, which is impervious to any accidental liquid spills. Its fingerprint-proof LCD screen with a clear UI interaction page makes it easy for everyone to control the meeting. CP925 has 7 built-in microphones, providing you with a clear and natural conference call experience.

Modest Design, Easy-to-Use User Interface

Yealink CP925 is a hermit in the conference room. Its black acoustics fabric can realize crystal-clear audio and is resistant to water, oil, and stain. Its ultra-thin body, appropriate desktop fit, and ingenious hidden wiring slot, perfectly fit for the simple business style in the conference rooms. Additionally, its built-in Linux system and easy-to-use UI interface, allow users to launch a meeting with one button and increase user adoption.

HD Audio, Smooth Communication

CP925 adopts Y-shaped design and has 6 built-in microphones for sound pickup and 1 microphone for noise cancellation. Its 20-foot and 360° omnidirectional sound pickup provide users with clear and natural voice conference experience.

AUDIO FEATURES

- Optimal HD audio
- Yealink Noise Proof Technology
- Smart Noise Filtering
- 20-foot (6-meter) microphone pickup range
- Apply to small to medium conference room
- Built-in 6-microphone array, 360-degree voice pickup
- Loudspeaker
 - Frequency: 100-20,000 Hz
 - Volume: 94dB at 0.5-m peak volume
- 56mm diameter and 5w speaker
- Full-duplex speakerphone with AEC
- Echo cancellation tail length is up to 320ms
- Background noise suppression
- Codecs: G.726, G.729, PCMU (G.711A), PCMA (G.711μ)
- DTMF: In-band, Out-of-band (RFC 2833) and SIP INFO
- VAD, CNG, PLC, AJB, AGC

PHONE FEATURES

- 1 SIP account
- Call hold, mute, DND, call recording, hotline
- 5-way conference call
- Redial, call waiting, emergency call
- Call forward, call transfer, call return, dial plan
- Ring tone selection/import/delete
- Set date time manually or automatically
- Volume adjustment
- Pairing via Bluetooth
- Active Speaker

DIRECTORY

- Local phonebook up to 1000 entries
- XML/LDAP remote phonebook
- Intelligent search method
- Phonebook search/import/export
- Call history: dialed/received/missed/forwarded

IP-PBX FEATURES

- Busy Lamp Field (BLF)
- Multicast paging
- Intercom
- Anonymous call

- Anonymous call rejection
- Voice mail
- Distinctive ringtone
- all pickup

DISPLAY

- 4" 480x800 capacitive touch screen
- Volume key

INTERFACE

- 1 x RJ45 10/100M Ethernet port
- Built-in Wi-Fi (2.4GHz/5GHz, 802.11a/b/g/n)
- Built-in Bluetooth 4.2
- Power over Ethernet (IEEE 802.3af), class 3
- 1 x USB 2.0 Type-C device port
- 1 x Security slot

NETWORK AND SECURITY

- SIP v1 (RFC2543), v2 (RFC3261)
- SIP server redundancy supported
- IPv4/IPv6
- NAT traversal: STUN mode
- Proxy mode and peer-to-peer SIP link mode
- IP assignment: static/DHCP
- HTTP/HTTPS web server
- Time and date synchronization using SNTP
- UDP/TCP/DNS-SRV (RFC 3263)
- QoS: 802.1p/Q tagging (VLAN), Layer 3 ToS, DSCP
- SRTP for voice encryption
- Transport Layer Security (TLS1.3)
- HTTPS certificate manager
- AES encryption for configuration file (AES256)
- Adb encryption authenticated
- Digest authentication using MD5/MD5-sess
- OpenVPN, L2TP VPN
- WPA2/WPA3 • Secure boot
- GARP (Generic Attribute Registration Protocol)

MANAGEMENT

- Configuration: browser/phone/auto-provision
- Auto provision via FTP/TFTP/HTTP/HTTPS for mass deploy
- Auto-provision with PnP
- Zero-sp-touch, TR-069
- Reset to factory, reboot
- Package tracing export, system log

OTHER PHYSICAL FEATURES

- Color: Black
- External Yealink PoE adapter (optional)
- Power consumption (PSU): 3.5W-11W
- Power consumption (PoE): 4W-12W
- Dimension (W*D*H): 285mm*289.5mm*59.1mm
- Operating humidity: 10~90%
- Storage temperature: -10~40°C (+14~104°F)

PACKAGE FEATURES

- Package content:
 - Yealink CP925 IP conference phone
 - Ethernet Cable (7.5m CAT5E UTP cable)
 - M2x5 screw
 - Screwdriver
 - Wireless Microphone CPW25 (Optional)
 - Quick Start Guide
 - Yealink PoE Adapter YLPOE30 (Optional)
- Qty/CTN: 5 PCS
- N.W/CTN: 7.036 kg
- G.W/CTN: 8.106 kg
- Giftbox size: 355mm*349mm*108mm
- Carton Meas: 567mm*357mm*365mm

COMPLIANCE

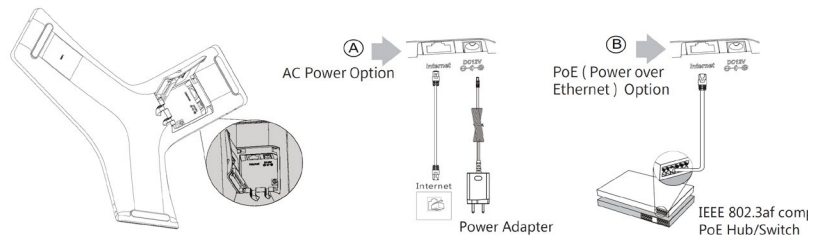

Intermedia has been recognized by J.D. Power for providing "An Outstanding Customer Service Experience" for its Assisted Technical Support. J.D. Power 2021 Certified Assisted Technical Program, developed in conjunction with TSIA. Based on successful completion of an audit and exceeding a customer satisfaction benchmark for assisted support operations. For more information, visit www.jdpower.com or www.tsia.com.

Questions? Contact Us Today.